

Year 3-6: How to sign in to Seesaw Class

1. Open the Seesaw Class App or go to the Seesaw website at *app.seesaw.me* using Chrome

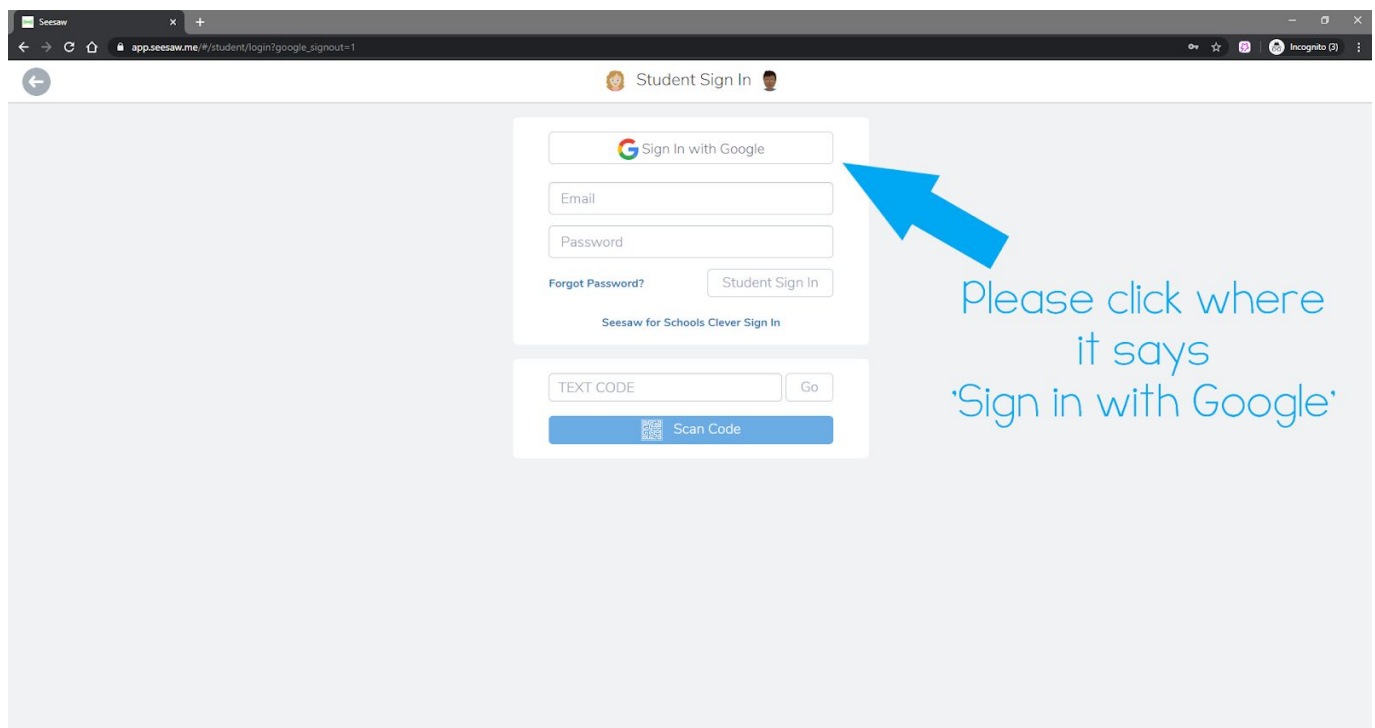

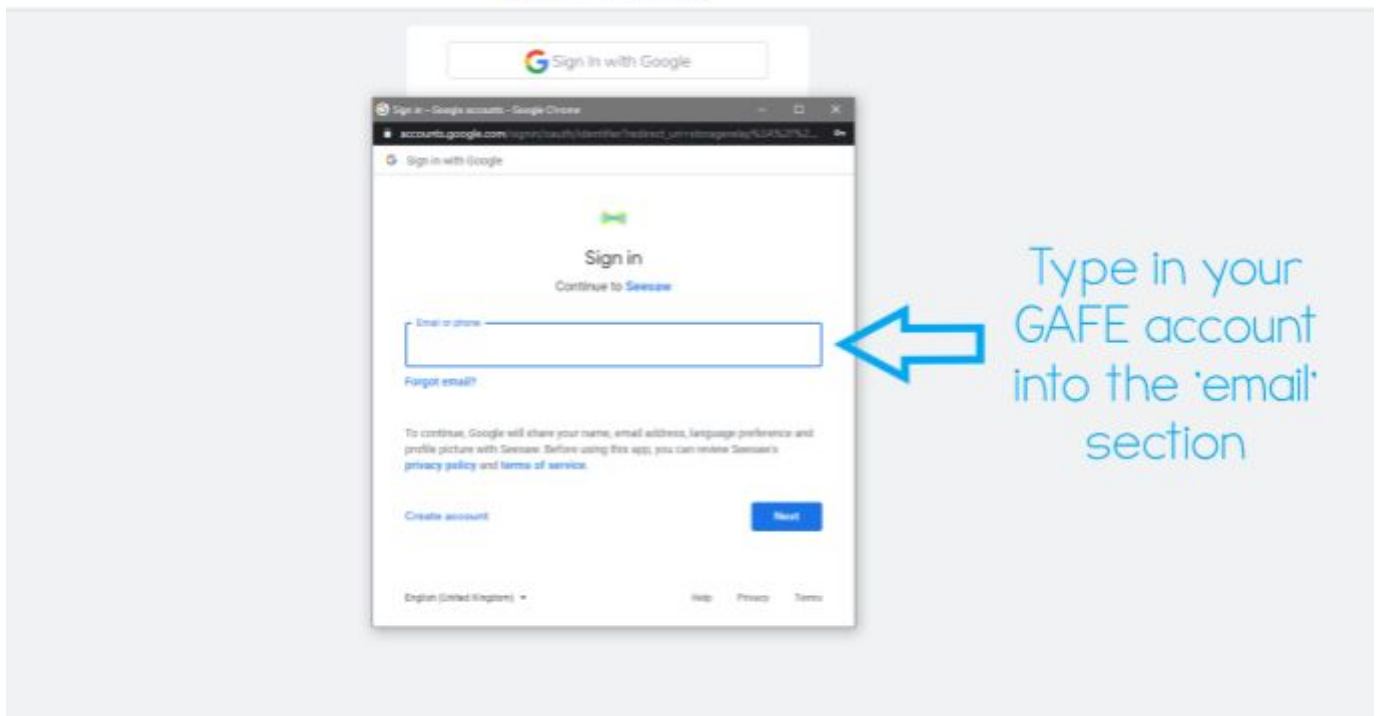

Type in your GAFE account into the 'email' section

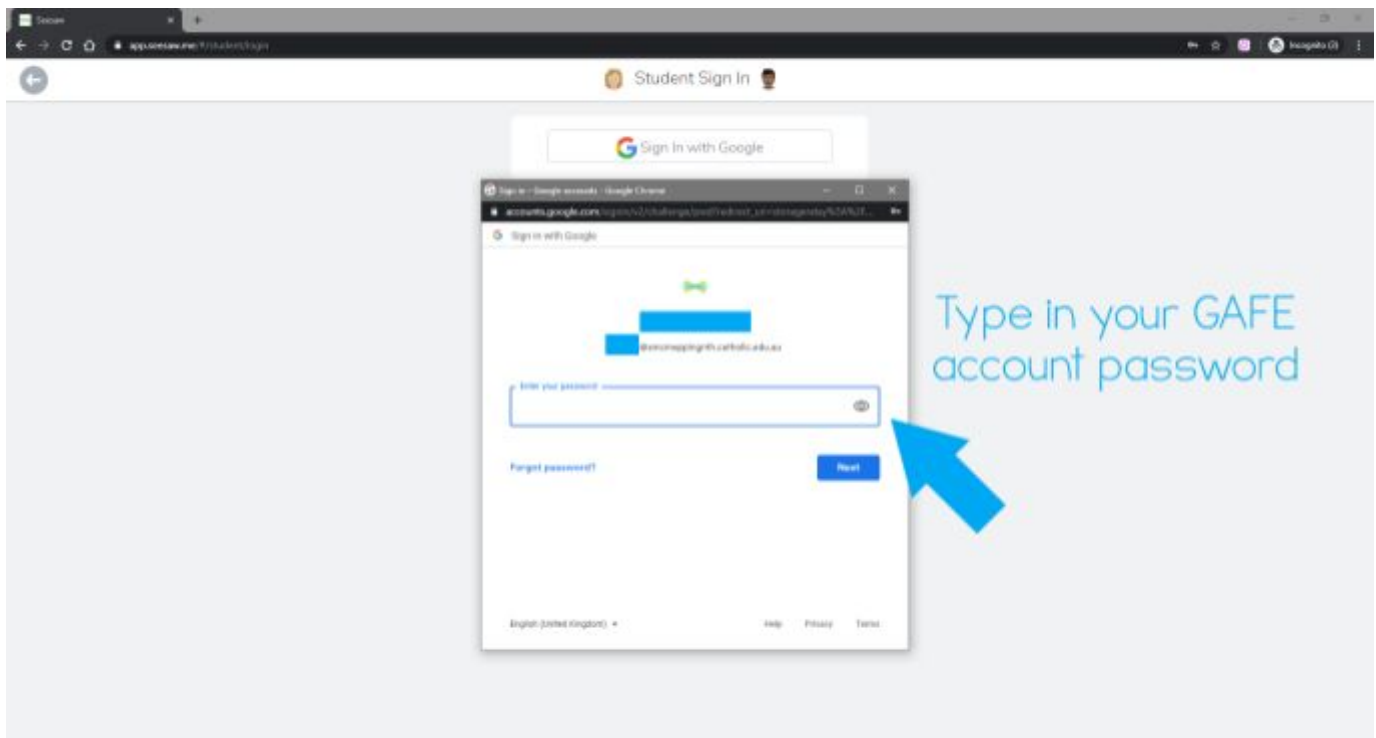

Type in your GAFE account password

Click 'Next' for you to complete the sign in process! You might have to do this both on your Chromebook and on the Seesaw Class app depending on how you like to share your learning.

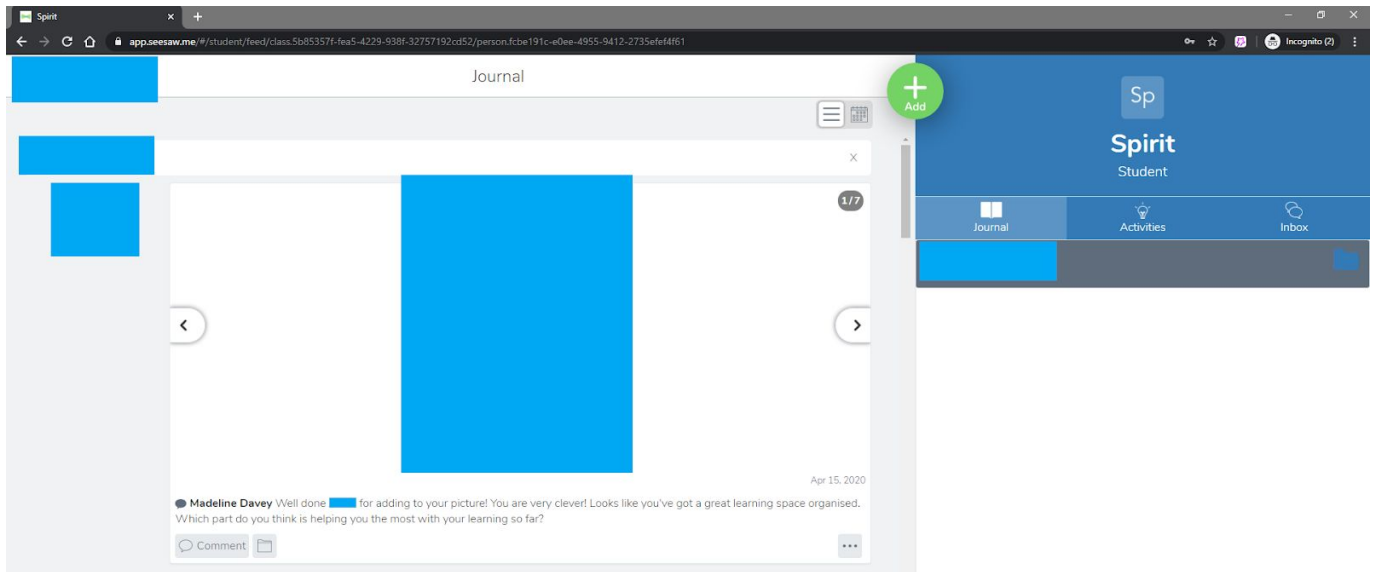

You should now be able to see the above screen as you would have before! You now have access to share your learning with your homegroup teacher! We can't wait to see what learning you've been doing!